

Fan

MHF - 400/500

Geovent MHF is a centrifugal fan with backward curved closed B-impeller and direct driven motor.

MHF fan is used for industrial process ventilation.

Strong pressure fan, which is suitable for reduced air-flow, rates at relatively high pressure.

For example, use MHF in connection with sanding dust.

Suitable for PID / constant pressure regulation.

The fan is made of galvanized steel and is therefore suitable for outdoor installation on a roof or wall.

For MHF fan Geovent offers a variety of accessories consisting of among others flex connections, mounting brackets, rain shield, motor protection, pressure guard and sound box.

The MHF fan is supplied as standard with vibration damping feet, inlet spigot with mesh and factory outlet flange.

Airflow rates up to 4000 m³/h

Press up to: 11.000 Pa using the a frequency converter

Electrical Data / Other Data / Features

Engine: Direct drive with B5 flange motor protection class IP 55

Voltage: 3x400V / 50 Hz

MHF-400: Q = 1.000 m³/h at 1.700Pa

MHF-500: Q = 1.000 m³/h at 3.800Pa

HOUSE: Made of hot galvanized sheet metal. All screws and bolts are galvanized. Incl. bear feet with vibration dampers, inlet spout with net and factory-fitted outlet flange.

Temperature range

Ambient temperature: + 40°C

Temperature exhaust air: + 80°C

Audio data

MHF-400 = 86dB (A)

MHF-500 = 93dB (A)

Testet iht. ISO 5801.

The fan is also supplied in ATEX version according to the 2014/34/EU directive. Then the type is called LEX/MEX, and it is supplied as standard with EExE motor. Other variants are offered on inquiry.



Ordering table

Art. No.	Description
35-450	MHF-400-3 1,1 kW 2800 rpm
36-550	MHF-500-3 4 kW 2800 rpm

Pressure drop

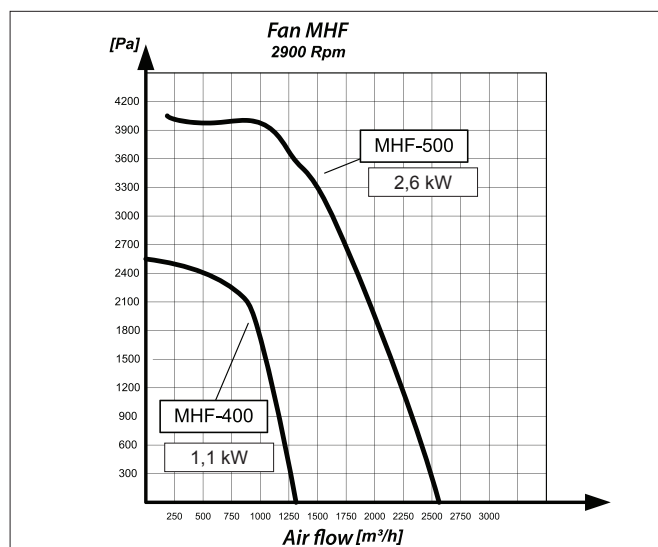

Dimensions MHF-400

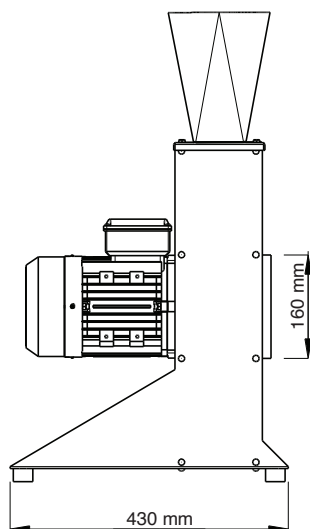
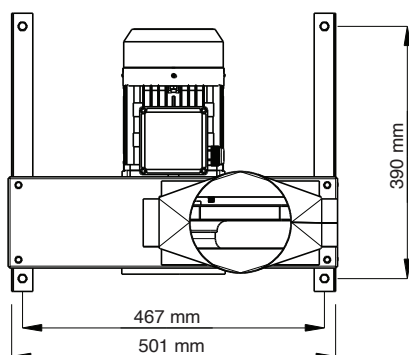
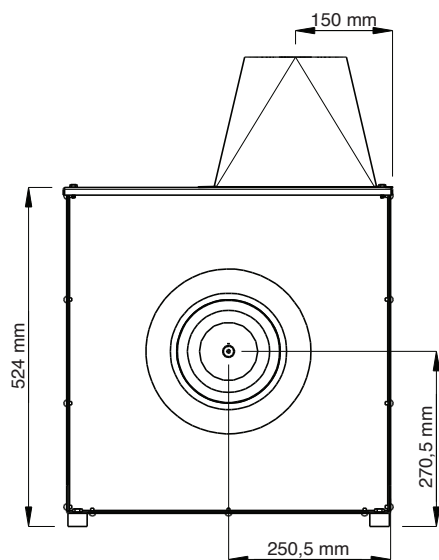

Dimensions MHF-500

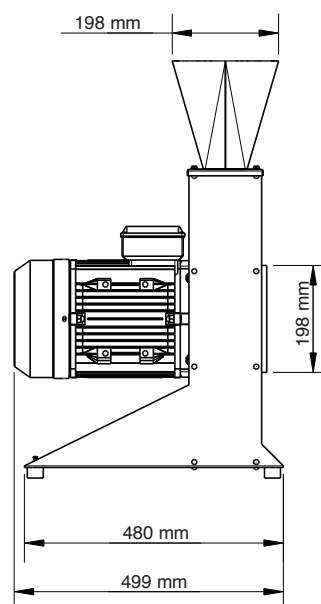
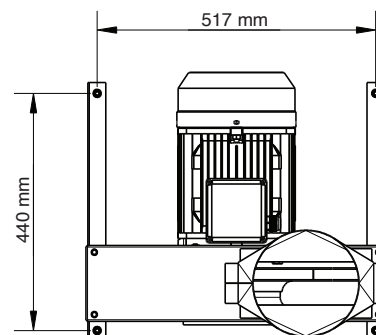
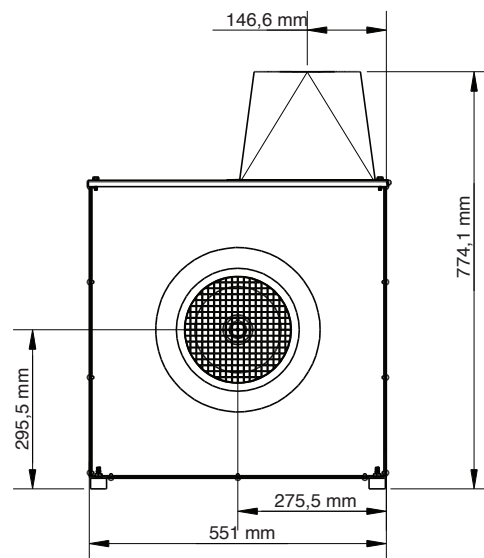

ATEX fan MHFX

Our series of atex fans with backward curving impellers are as standard supplied with EEx e motors, but can also be supplied with EEx d or EEx de motors.

The typical scope of application is zone 1, zone 2 and zone 22.

The construction is based on standard LEF/MEF, but has beside the ATEX motor, also protection against static and sparks in inlet.

For ATEX applications, where acid proof execution is needed, this can be offered. All plate parts, screws and bolts a.s.o. are supplied in Acid proof ANSI 316L and are subsequently stained. The wheel is either supplied in a special lacquered edition or in ANSI 316L.

NB: All volume current curves are as standard only 50 hz, in LEX/MEX atex versions.

MHFX is incl. outlet flange.

Varenr.	Model	(kW)	(volt)	(Ampere)
37-650	MHFX 400-3	1,1	3x400	2,6
37-651	MHFX 500-3	4,1	3x400	8,1

Accessories

Our series of MHF fans are available as accessories.



Ordering table

Art. no.	Description
30-087	Sound box MHF 400
30-088	Sound box MHF 500

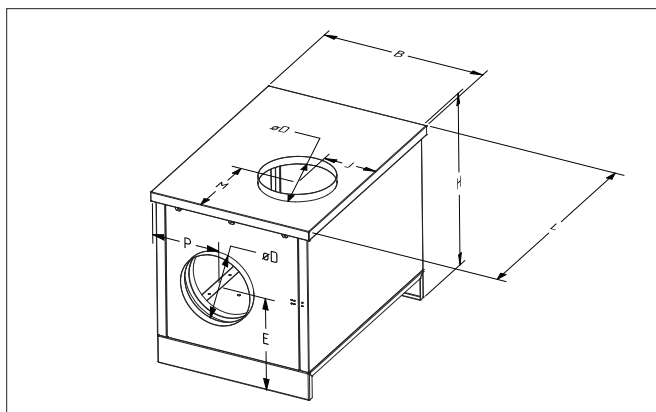

Type	B	H	L	øD	R	P	M	J	Weight
MHF 400	715	1002	784	160	405	352	202	254	90 kg
MHF 500	715	1002	784	202	430	342	202	229	95 kg