

Exhaust Extraction

Channel Duct - Type 25 in extruded aluminum

The Geovent Channel Duct, type 25, is for the extraction of exhaust gas and welding fumes etc. With a length of up to 48 m, the Channel Duct ensures a large working area for the operator, who is not dependent on a fixed working area, since the trolley may be moved to the required place. The duct may be equipped with up to six trolleys in total. The channel duct is utilised optimally in test stands with linear flow, and in medium and large garages.

Easy operation:

The trolley type 30 is equipped with 8 smoothly rolling nylon wheels, ensuring easy movement of the trolley. Furthermore, having heavy, rolled-out hoses on the floor is avoided. The Channel Duct is available with a substantial variety of accessories, easing the daily work of the operator: Electrical control, wireless forward and return of the trolley, compressed air nozzles for automatic dismounting from the exhaust pipe etc.

Easy installation:

We have made great efforts to ensure the easy installation of our Channel Duct with accessories.

We shall be pleased to help with the dimensioning of your new Channel Duct system.

Cross section of channel duct

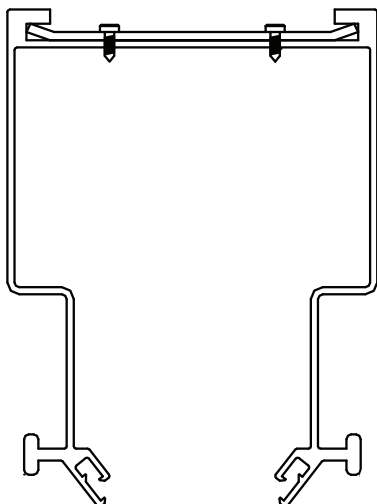

Trolley with hose, balancer, and nozzle

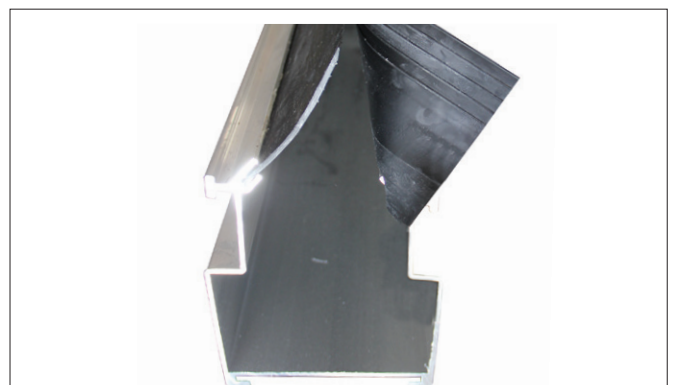

Rubber sealing lip on the channel duct

Pressure drop of GeoFlex Exhaust hose

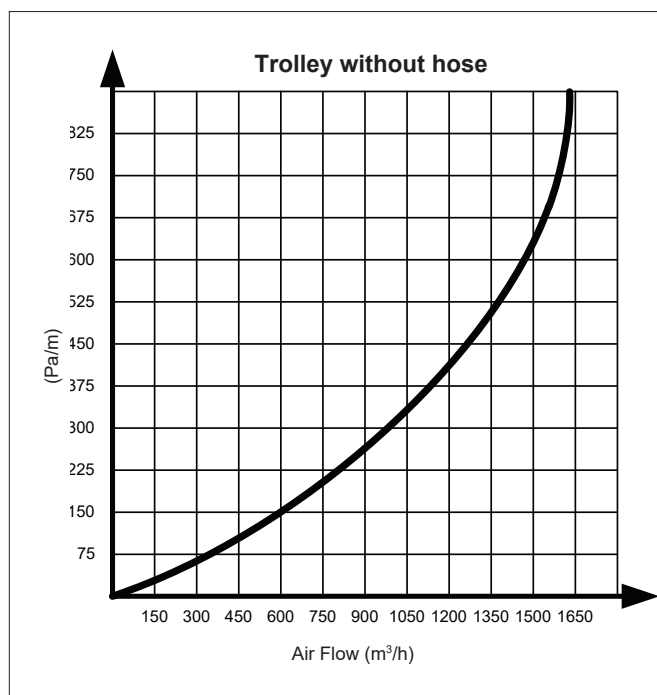
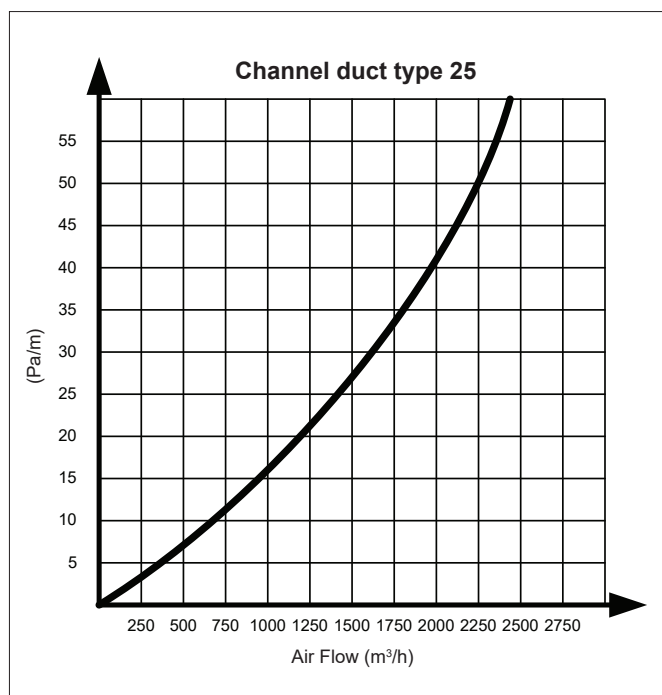
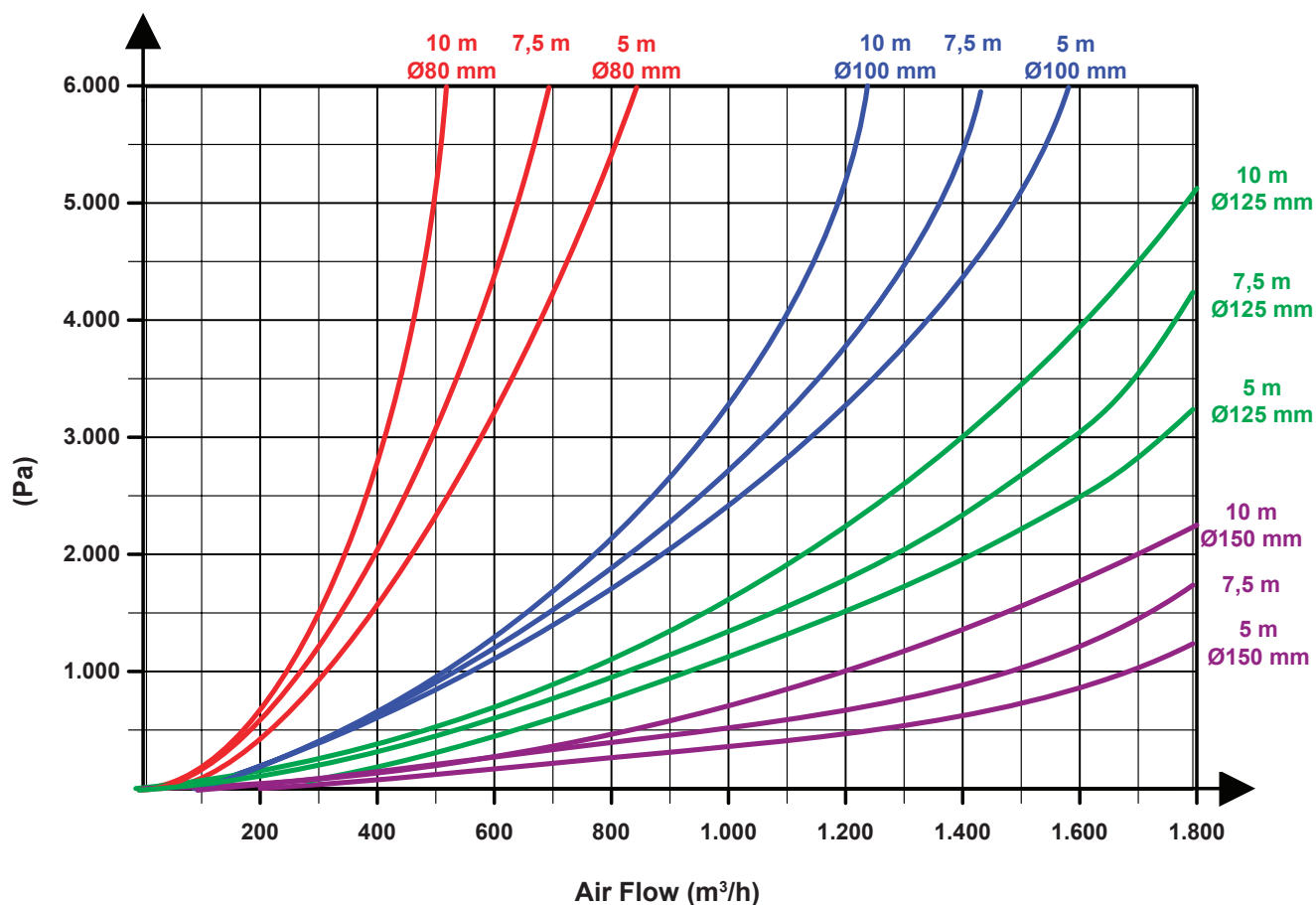

Channel Duct - Type 25 in extruded aluminum

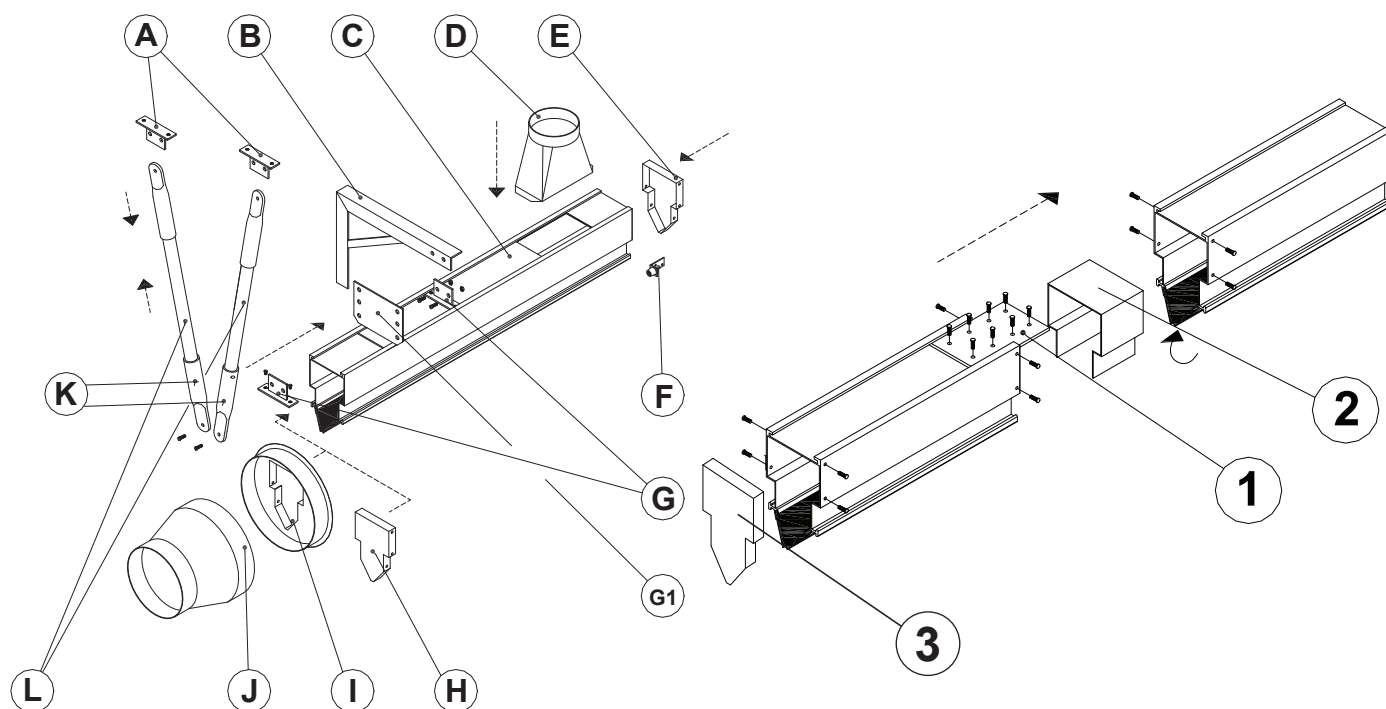

Ordering table for Channel Duct

Pos.	Art. No.	Description
A	07-662	Ceiling bracket- tilt function
B	07-150	Wall bracket 146-200
B	07-151	Wall bracket 225-250
B	07-152	Wall bracket 315-355
B	07-153	Wall bracket 400-450
C	07-400	Channel duct, type 25 with rubberlip
	07-400A	Reinforcement for channel duct
D	07-408	Outlet ø160 mm, top
D	07-409	Outlet ø200 mm, top
E/H	07-403	End cover type 25
F	07-477	End stop for trolley 39x32mm
G	07-656	Suspension bracket type 60
G1	07-655	Suspension bracket type 160
I	07-406	End reduction nipple ø250mm
J	56-064	Reduction, sleeve ø250/Np ø160
J	56-065	Reduction, sleeve ø250/Np ø200
K	07-422	Sleeve bracket f/spacer tubes - 2
L	07-424	Spacer tube 3/8" galvanized
A + G + K + L	07-620	Suspension package 1m f/channel
A + G + K + L	07-621	Suspension package 2m f/channel
A + G + K + L	07-622	Suspension package 3m f/channel
1 + 2	07-401	Channel connection part
3	07-403	End cover type 25



Channel Duct - Type 25 in extruded aluminum

Ordering table for Channel Duct

Pos.	Art. no	Model
G	07-656	Suspension bracket, type 60, in galvanised steel. Used both for mounting in the ceiling and on the wall (one required per 2-4 m duct). To be replaced by 07-655, suspension bracket, type 160, when mounted on the side of a concrete beam
K	07-422	Coupling bracket for spacer pipe (set of two), galvanised. Two sets required per point of fixation.
L	07-424	Spacer pipe 3/8", galvanised for 07-422 coupling bracket (required number = 4 x eight from duct to ceiling)
A	07-662	Rocking bracket for ceiling installation. Two brackets required per point of fixation
G1	07-655	Suspension bracket, type 160, galvanised plate for installation on the side of a concrete beam. Three installation on heights (07-456 suspension bracket, type 60 is not required when using this type of bracket).

The Geovent Channel Duct is suitable for ceiling or wall installation or on the side of a concrete beam. Geovent has developed a set of various brackets, facilitating the installation of the Channel Duct. The bracket should be mounted every 2-4 m.

Hose suspension bracket parts for Channel Duct

Pos.	Art. no.	Model
-	56-042	Reduction MF160/NP80
-	56-043	Reduction MF160/NP100
-	56-044	Reduction MF160/NP125
-	56-045	Reduction MF160/NP150
-	04-460	Adapter for mounting WING/COMPACT arm on trolley 30
-	06-600	Safety coupling ø100 mm
-	06-602	Safety coupling ø150 mm
-	07-712	Multi - hose suspension on LWS in neoprene rubber/galvanised steel. For hose sizes ø76 - ø152 mm. Used in connection with spring balancers (Z)

Pos.	Art. no.	Model
-	07-420	Trolley type 30, powder coated steel. Complete with 8 smooth-running nylon wheels. Ø160 mm NP connection. For air flows up to 1.200 m³/h.
-	07-430	Trolley 2000M. 8 wheels and ø250 mm NP (L=1.000mm, W=200mm, H=289mm). For air flows up to 2.000m³/h.

Description of channel duct

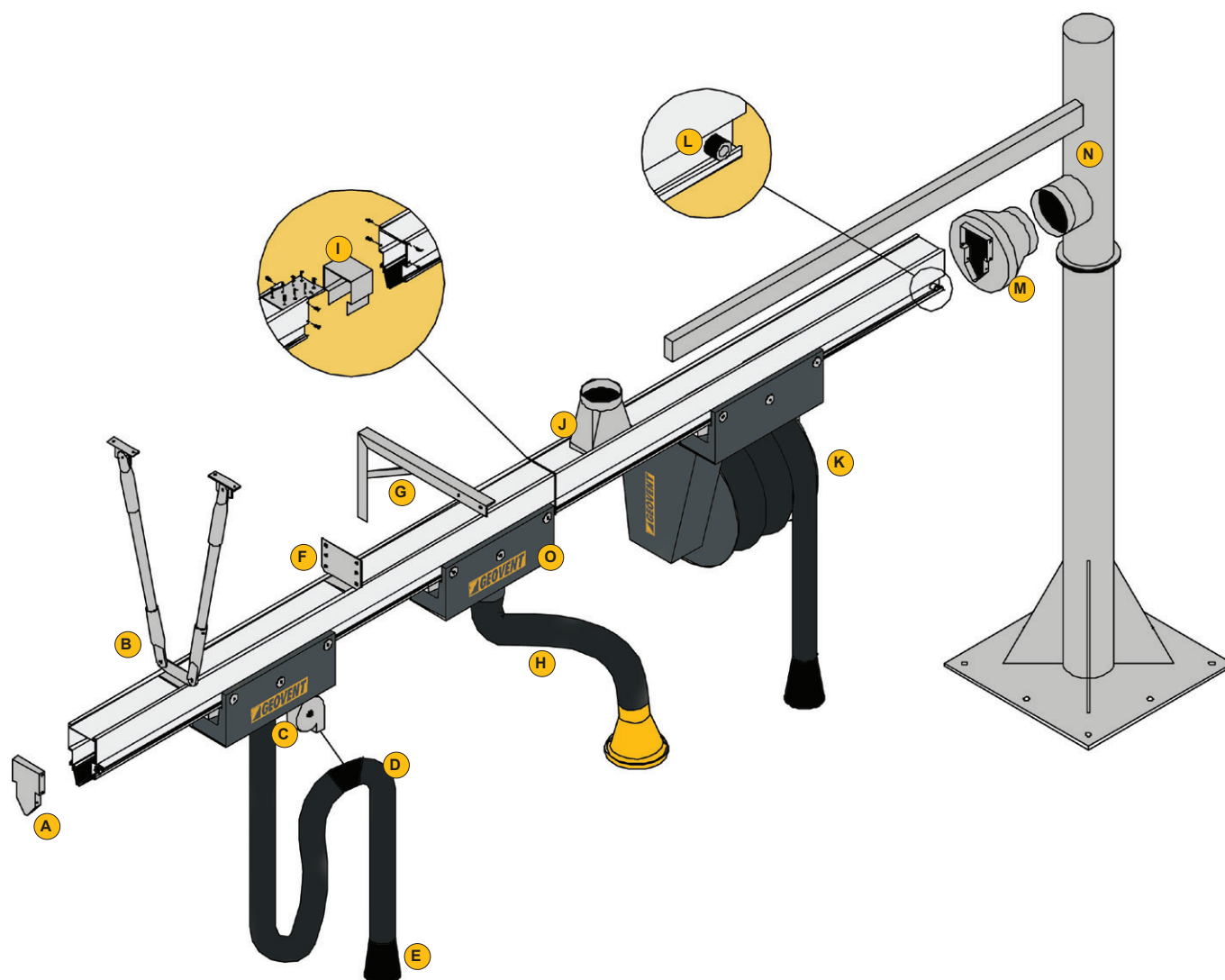

- A: End cover
- B: Ceiling bracket
- C: Balancer
- D: Hose mount LWS
- E: Rubber Nozzle
- F: Suspension Bracket type 160
- G: Wall mount
- H: Extraction Arm
(WING/COMPACT)
- I: Connection
- J: Outlet Flange, top
- K: Hose Reel with Nozzle
- L: End stop
- M: Channel reduction, end
- N: Pivotal arm 180° or 360°
- O: Trolley type 30



Channel Duct - Type 25 in extruded aluminum

Accessories

We have a full range of standard products, but also various accessories

- Wireless automation
- Spring balancer can be mounted from the start or later
- Hoses and nozzles are available for special needs
- Accessories for test stands with linear flow

Contact Geovent for more information

Examples of special solutions





Channel Duct - Type 25 in extruded aluminum

Examples from installations

